

FILE: Z:\SPECIALTY CONTRACT SEED DIRECTORIES\CONSTRUCTION DRAFTING STANDARDS AND TEMPLATES\DEV\SMPL-EXP-UPRODUCT\12345678C-106.DWG | DATE: Monday, November 21, 2022 2:01:40 PM

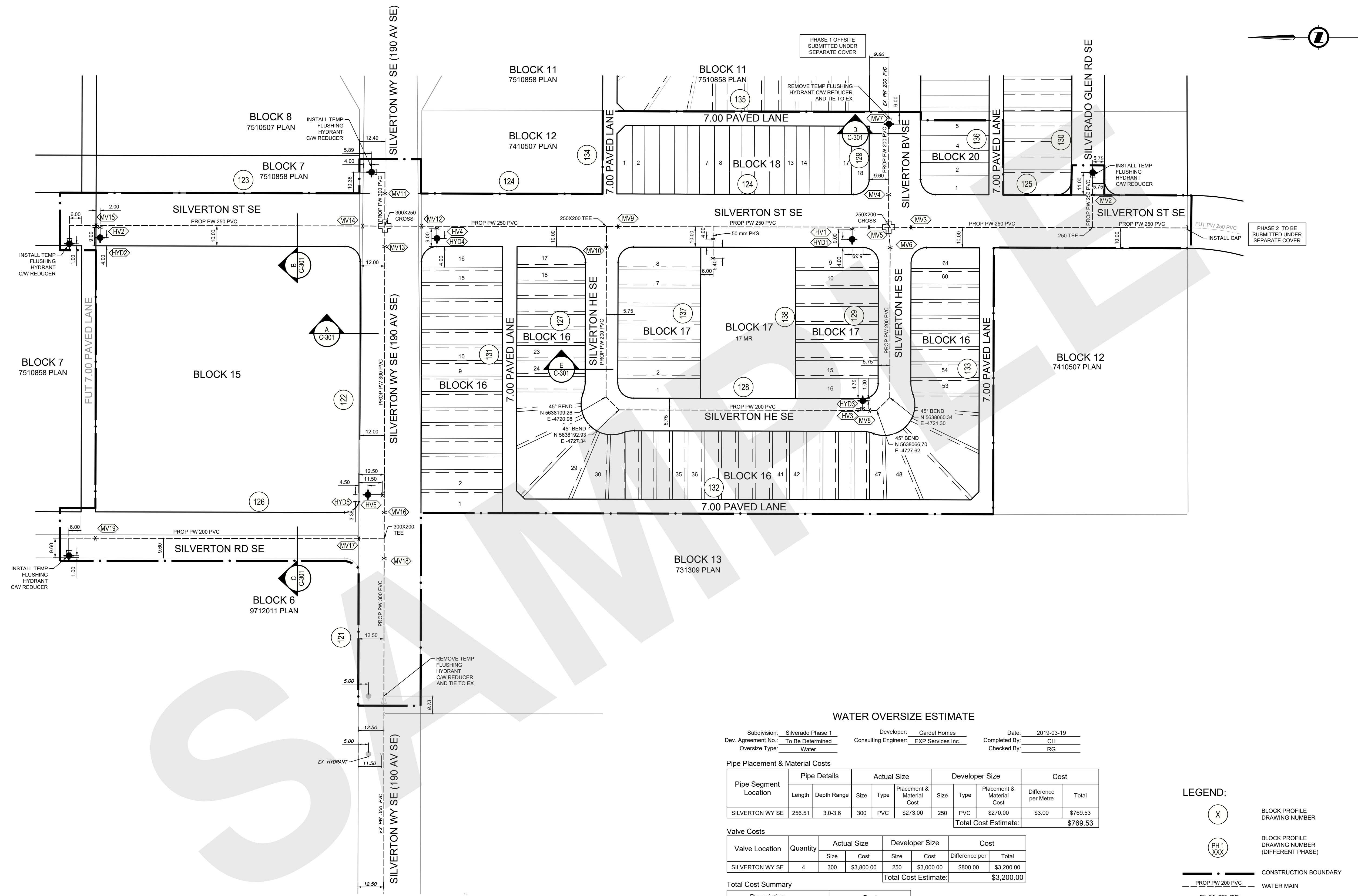

**NOTES**

- GENERAL NOTES (GN):**
- ALL PIPE SIZES ARE IN MILLIMETRES AND ALL DIMENSIONS ARE IN METRES UNLESS OTHERWISE NOTED
  - ALL COORDINATES AND DISTANCES ARE BASED ON 3TM COORDINATE SYSTEM (NAD 83)
  - ALL CONSTRUCTION AND MATERIALS TO BE IN ACCORDANCE WITH CURRENT CITY OF CALGARY SPECIFICATIONS.
  - NO CONSTRUCTION SHALL PROCEED UNTIL ALL APPROPRIATE REGULATORY APPROVALS ARE OBTAINED.
  - ALL PLANS SUBJECT TO TERMS OF THE DEVELOPMENT AGREEMENT/PERMIT AND THE CONTRACT DOCUMENTS.
  - ANY ERRORS OR DISCREPANCIES TO BE REPORTED TO THE ENGINEER PRIOR TO COMMENCEMENT OF CONSTRUCTION
  - ALL FILL MATERIAL SHALL BE PLACED AND COMPACTED TO CITY OF CALGARY SPECIFICATIONS.
  - ALL ELEVATIONS ARE GEODETIC.
  - CONTRACTOR TO BE RESPONSIBLE FOR LOCATION AND ALIGNMENT OF ALL EXISTING UTILITIES.
  - CONTRACTOR TO TAKE CARE WHEN WORKING NEAR EXISTING INFRASTRUCTURE.
  - CONTRACTOR TO COORDINATE ALL CONSTRUCTION WITH ASSOCIATED OWNER(S) WHEN WORKING NEAR EXISTING INFRASTRUCTURE.
  - EXISTING SURFACE FEATURES TO BE RESTORED TO CONDITIONS PRECEDING CONSTRUCTION WHERE EXISTING CONDITIONS WILL BE MAINTAINED.
  - COMBINED FACTOR APPLIED=0.999796 (1.000204)
  - ALL NORTHING-EASTING COORDINATES ARE AT SEA LEVEL.

- WATER MAIN NOTES (WMN):**
- ALL WATER MAIN TO BE PVC DR15 UNLESS OTHERWISE NOTED.
  - ALL PIPE BACKFILL SHALL SATISFY THE MINIMUM WATERWORKS SPECIFICATIONS WITH CLASS 1A BEDDING.
  - MINIMUM DEPTH TO PIPE CROWN SHALL BE 3.00 METRES.
  - ALL WATER MAINS AND APPURTENANCES MUST BE PROPERLY TESTED PRIOR TO UTILIZATION.
  - PRIOR TO COMMENCING AND DURING ANY PRESSURE TESTING, CHLORINATING, OR FLUSHING OF MAINS, A WATER SERVICES INSPECTOR MUST BE ON SITE.
  - NO HYDRANTS ARE TO BE USED FOR CONSTRUCTION WATER UNLESS OTHERWISE AUTHORIZED.
  - EXACT LOCATION OF ALL EXISTING INFRASTRUCTURE (HORIZONTAL AND VERTICAL) TO BE CONFIRMED IN THE FIELD BEFORE CONSTRUCTION BEGINS.
  - WATER INFRASTRUCTURE TO MAINTAIN A MINIMUM 3.00 SEPARATION FROM TREES, STREET LIGHTS, AND CATCH BASINS.
  - ALL EXISTING WATER MAINS ARE OPERATIONAL AND MUST BE MAINTAINED AS SUCH DURING CONSTRUCTION OR SUITABLE ALTERNATE SERVICE CONDITIONS PROVIDED.
  - ALL EXISTING WATER MAINS SHOWN ARE PART OF OTHER SCOPES OF DEVELOPMENT AND INCLUDED IN SEPARATE DRAWING SUBMISSION SETS.
  - FOR COLLECTOR ROAD TRAFFIC VOLUMES & GREATER, INSTALL DEEP VALVE BOX LIDS AS PER CITY OF CALGARY STANDARD SPECIFICATIONS: WATERWORKS CONSTRUCTION SPEC 453.1006.006p12.



NAD 83 COORDINATES

ISSUED FOR PRELIMINARY APPROVAL

NO.	DESCRIPTION	DATE (YYYY-MM-DD)	BY	APPD
0	ISSUED FOR PRELIMINARY APPROVAL	2019-11-14	RCM	RG

DESIGNED	BY	DATE (YYYY-MM-DD)
DRAWN	LH	2018-07-09
CHECKED	RG	2018-09-01

SCALE	1:1000
-------	--------

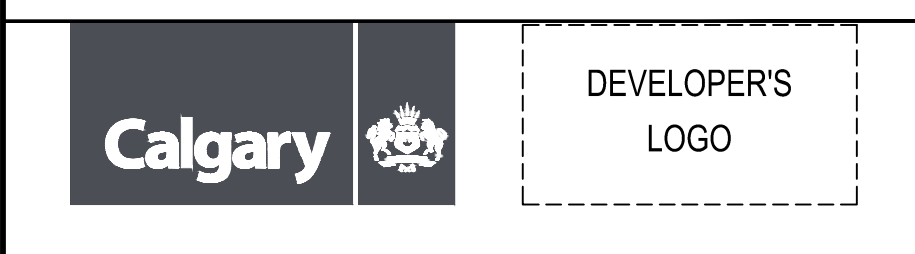

PROJECT  
**THE CITY OF CALGARY  
CONSTRUCTION DRAFTING STANDARDS  
AND TEMPLATES**  
SEC: 22 - TWP: 22 - RGE: 01 - W 5th M

SHEET TITLE	<b>SUBDIVISION WATER MAINS SAMPLE SHEET</b>		
FILE NO.	12345678C-106.dwg	ENG DWG NO.	
SHEET ID.	<b>C-106</b>	SHEET NO.	<b>008</b>
DRAWN	BY	DATE (YYYY-MM-DD)	PROFILE NO.

**WATER OVERSIZE ESTIMATE**

Subdivision: Silverado Phase 1 Developer: Cardel Homes Date: 2019-03-19  
 Dev. Agreement No.: To Be Determined Consulting Engineer: EXP Services Inc. Completed By: CH  
 Oversize Type: Water Checked By: RG

Pipe Placement & Material Costs

Pipe Segment Location	Pipe Details		Actual Size		Developer Size		Cost			
	Length	Depth Range	Size	Type	Placement & Material Cost	Size	Type	Placement & Material Cost	Difference per Metre	Total
SILVERTON WY SE	256.51	3.0-3.6	300	PVC	\$273.00	250	PVC	\$270.00	\$3.00	\$769.53
<b>Total Cost Estimate:</b>									<b>\$769.53</b>	

Valve Costs

Valve Location	Quantity	Actual Size		Developer Size		Cost	
		Size	Cost	Size	Cost	Difference per	Total
SILVERTON WY SE	4	300	\$3,800.00	250	\$3,000.00	\$800.00	\$3,200.00
<b>Total Cost Estimate:</b>							<b>\$3,200.00</b>

Total Cost Summary

Description	Cost
Total Pipe Placement & Material Costs	\$769.53
Total Valve Costs	\$3,200.00
Subtotal	\$3,969.53
Administration (11.0%)	\$436.65
<b>Total Estimated Claim:</b>	<b>\$4,406.18</b>

NOTES:  
1. Calculations are based on the 2018 City of Calgary Development Agreement Rates

- LEGEND:**
- (X) BLOCK PROFILE DRAWING NUMBER
  - (PH 1 XXX) BLOCK PROFILE DRAWING NUMBER (DIFFERENT PHASE)
  - CONSTRUCTION BOUNDARY
  - PROP PW 200 PVC WATER MAIN
  - EX PW 200 PVC EXISTING WATER MAIN
  - FUT PW 200 PVC FUTURE WATER MAIN
  - ◆ VALVE
  - ◆ HYDRANT w/ VALVE
  - ◆ EXISTING HYDRANT w/ VALVE
  - CAP
  - REDUCER
  - ◇ (MV1) WATER MAIN VALVE NUMBER
  - ◇ (HYD) HYDRANT NUMBER